

## BW 23000 (2V300Ah)

### SPECIFICATIONS

Nominal Voltage		2 V						
Capacity (25°C)	10HR	300 Ah						
	3HR	234 Ah						
	1HR	174 Ah						
Dimension	Length	171±2mm (6.72inch)						
	Width	151±2mm (5.94inch)						
	Height	330±2mm (12.99inch)						
	Total Height	364±2mm (14.33inch)						
Approx. Weight		18kg (39.7lbs) ±4%						
Terminal type		F12						
Internal resistance (Fully charged, 25°C)		Approx. 0.8m Ω						
Capacity affected by temperature (10HR)	40°C	102%						
	25°C	100%						
	0°C	85%						
	-15°C	65%						
Self-discharge (25°C)	3 month	Remaining Capacity: 91%						
	6 month	Remaining Capacity: 82%						
	12 month	Remaining Capacity: 65%						
Nominal operating temperature		25°C ± 3°C (77°F ± 5°F)						
Operating temperature range	Discharge	-15°C ~ 50°C (5°F ~ 122°F)						
	Charge	-10°C ~ 50°C (14°F ~ 122°F)						
	Storage	-20°C ~ 50°C (-4°F ~ 122°F)						
Float charging voltage(25°C)		2.25 to 2.30V Temperature compensation: -3mV/°C						
Cyclic charging voltage(25°C)		2.42 to 2.50V Temperature compensation: -5mV/°C						
Maximum charging current		60A						
Maximum discharge current		2100 A(5 sec.)						
Designed floating life(20°C)		15~18 years						
Component	Positive plate	Negative plate	Container	Cover	Separator	Electrolyte	Safety valve	Terminal
Raw material	Lead dioxide	Lead	ABS	ABS	AGM	Sulfuric acid	Rubber	Copper



### DIMENSIONS

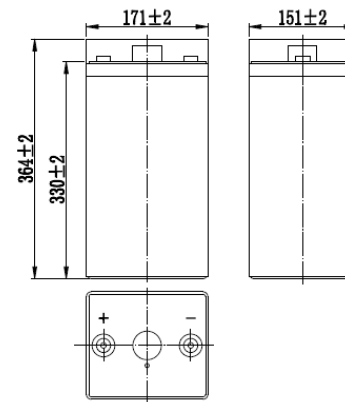

### TERMINAL

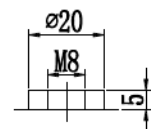

Terminal F12

### CONSTRUCTION

### CONSTANT CURRENT DISCHARGE CHARACTERISTICS (A, 25°C)

F.V/TIME	15min	30min	60min	2h	3h	4h	5h	6h	8h	10h	20h
1.60V	417	273	188	111	79.6	63.6	54.8	47.1	37.2	30.7	16.2
1.65V	407	268	185	110	79.1	63.3	54.5	46.8	37.0	30.6	16.2
1.70V	392	259	180	109	78.5	62.8	54.1	46.5	36.7	30.5	16.1
1.75V	379	253	176	107	78.0	62.4	53.7	46.2	36.5	30.4	16.0
1.80V	359	244	171	105	75.7	60.5	52.1	44.8	35.4	30.2	15.9

**CONSTANT POWER DISCHARGE CHARACTERISTICS (WATT, 25°C)**

F.V/TIME	15min	30min	60min	2h	3h	4h	5h	6h	8h	10h	20h
1.60V	763	511	356	213	156	125	108	92.8	74.0	61.1	32.4
1.65V	745	500	351	212	155	124	107	92.3	73.6	61.0	32.3
1.70V	717	485	342	210	154	123	107	91.7	73.0	60.8	32.2
1.75V	693	473	335	207	153	122	106	91.0	72.5	60.4	32.0
1.80V	656	456	325	202	148	119	103	88.3	70.4	60.0	31.8

Note: The above characteristics data can be obtained within three charge/discharge cycles.

**Discharge Characteristics (25°C)**

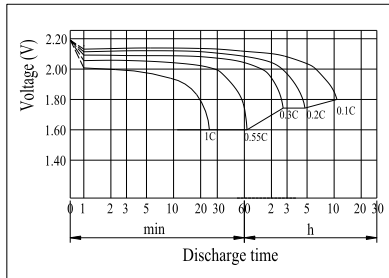

**Charging Characteristics (25°C)**

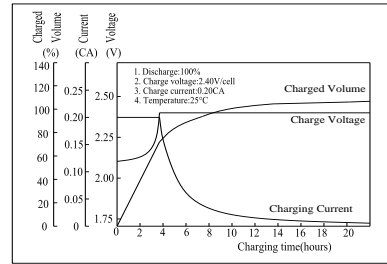

**The Relationship for Open Circuit Voltage and Residual Capacity (25°C)**

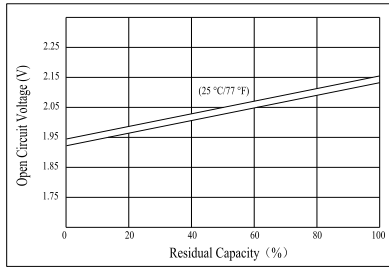

**The Relationship for Charging Voltage and Temperature**

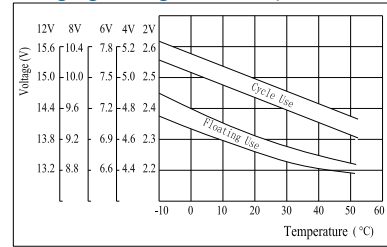

**Floating Life on Temperature**

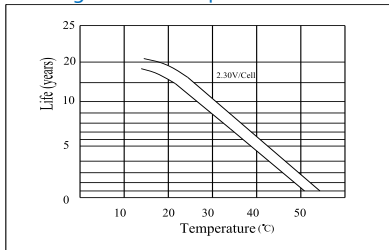

**Cycle Life on D.O.D (25°C)**

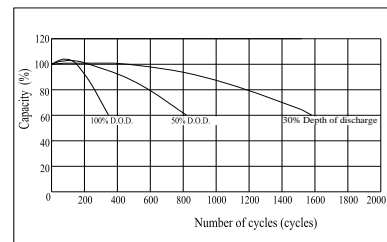

**Effect of Temperature on Capacity**

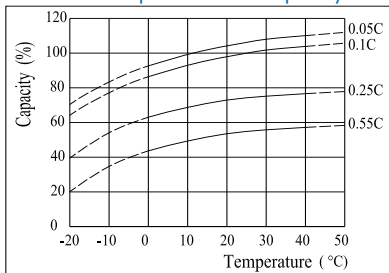

**Self-discharge Characteristics**

